

THE INTERNATIONAL
Luxury
PROPERTY SHOW

20-23 FEB 2014
DOWNTOWN MIAMI
ABOARD SEFAIR
THE MEGAYACHT VENUE



The Exhibition of Choice for the World's Leading Real Estate Brokers & Developers





A Stunning Showcase of Fine International Properties

Since its launch seven years ago, companies from around the globe have chosen **The Luxury Property Show** in London as the perfect event to promote and sell their properties.

We are pleased to announce the new international Miami edition of the show: **The International Luxury Property Show (ILPS)**, from February 20-23, 2014 aboard the most unique and exquisite venue available today: SeaFair, the megayacht venue.

More than 75 developments, brokers, and/or representatives will gather in spectacular downtown Miami aboard Seafair to present a global offering of real estate opportunities to affluent, discriminating consumers from throughout the United States, Canada, Europe, Latin America, and the Caribbean.





ABOUT MIAMI

Miami is America's fifth largest metropolitan area with a population of over 5 million residents. It offers a variety that goes far beyond sun and sand, encompassing world-renowned art galleries, first-class hotels, 5-star dining and nightlife all encapsulated in a unique architectural style that makes it one of the world's most visually distinctive regions.

- Ranked as the world's fifth-richest city in terms of purchasing power according to a 2009 UBS study of 73 world cities
- 25% of the world's wealth resides in South Florida during the winter season
- The Sabadell Financial Center, one of the premier office towers in downtown Miami sold for \$184 million in April 2013, the highest price ever paid for an office building in the area.



An Exclusive Venue & International Location for a World Class Show

The spectacular selection of properties that are sold at **The International Luxury Property Show** will be appreciated by HNW attendees by showcasing the developments in a refined, private and unique venue and location.

SeaFair is the world's first mobile megayacht venue and one of the ten largest privately owned yachts in the United States. Groundbreaking in scale, ingenuity and style, SeaFair - which remains dockside during each event - pairs international exhibitions with harbor view dining and special events in cities along the American eastern seaboard.

The \$40M purpose built yacht was designed by internationally acclaimed yacht designer Luiz De Basto. At 228 feet and 2800 international tons, it is the largest ship built for commercial operation in the Intracoastal Waterway and requires a draft of only 6.5 feet allowing it to dock at small yacht facilities in central city locations rather than use commercial ports.



Location

SeaFair will be docked in the heart of downtown Miami at the Bayfront South Dock next to the InterContinental Hotel Chopin Plaza Miami, FL 33131





The International Luxury Property Show at-a-Glance

LPS will commence with a Charity Gala Preview on Thursday evening, February 20th. Friday will be a private preview day for licensed brokers and agents – who may have key clients accompany them. On this day, the showcase will be open to pre-registered foreign and out-of state visitors. Saturday and Sunday will be public days with a full schedule of educational lectures and social events.

A unique feature of the showcase is that the scheduled show hours will be “Miami Time” from 1 – 10 PM. This is designed to leave morning hours for private meetings and site visits with clients.

Unlike a typical hotel or convention center setting, SeaFair and the surrounding Bayfront waterside environment is designed to heighten the tropical senses of visitors. The event will create a unique “club like environment” – from elegant meeting facilities to a sky deck bistro and bar designed to provide a luxurious and relaxed environment for visitors.

Typical attendee profile:

| | |
|-------------------------|-----------|
| Income Producing Assets | \$2.3M |
| Average net worth | \$5.1M |
| Average annual HHI | \$372,000 |

Age:

| | |
|--------------------------|-----|
| 18-34 | 9% |
| 25-49 | 52% |
| 50+ | 39% |
| College degree or higher | 71% |



Floor Plan

Booths are available as individual salons from 225-600 square feet or as shared salons as shown in floor plan and renderings. Spaces range in price from \$6,400 - \$32,000.

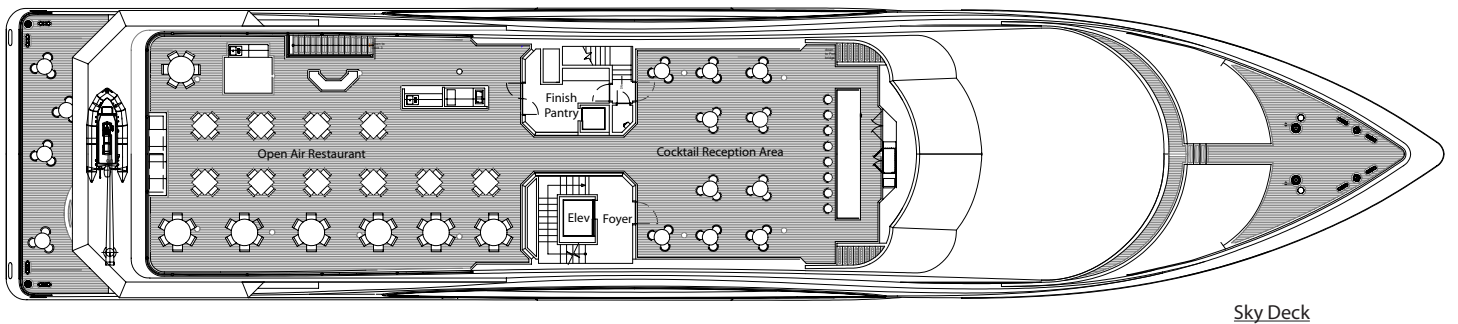
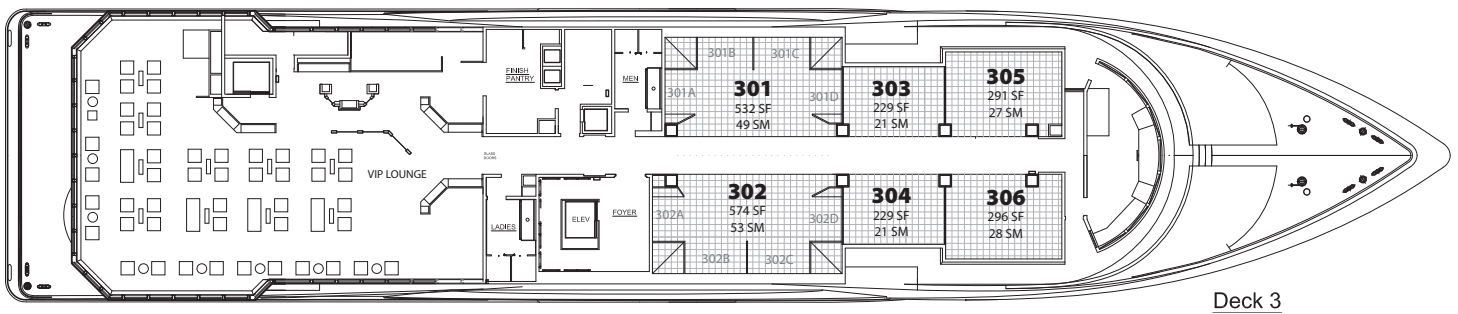
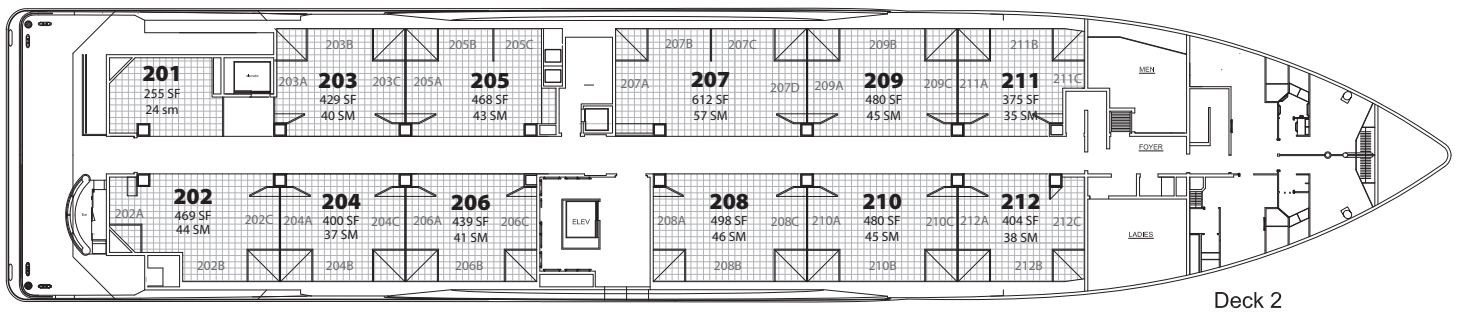
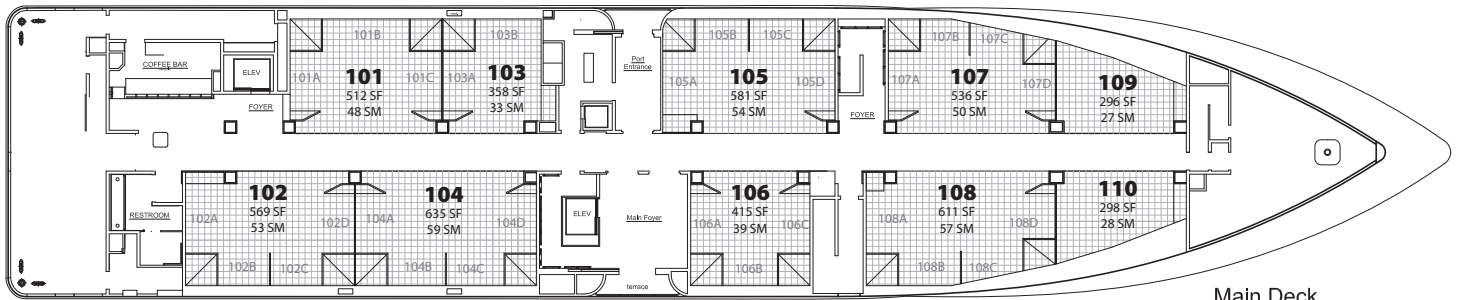

Pricing

| BOOTH # | SINGLE BOOTH PRICE | SHARED BOOTH PRICE (divided as shown) |
|---------|--------------------|--|
| 101 | \$25,600 | \$8,800 |
| 102 | \$28,450 | \$7,300 |
| 103 | \$17,900 | \$9,100 |
| 104 | \$31,750 | \$8,200 |
| 105 | \$29,050 | \$7,400 |
| 106 | \$20,750 | \$7,100 |
| 107 | \$26,800 | \$6,900 |
| 108 | \$30,550 | \$7,800 |
| 109 | \$14,800 | n/a |
| 110 | \$14,900 | n/a |
| 201 | \$12,750 | n/a |
| 202 | \$23,450 | \$8,000 |
| 203 | \$21,450 | \$7,300 |
| 204 | \$20,000 | \$6,800 |
| 205 | \$23,400 | \$8,000 |
| 206 | \$21,950 | \$7,500 |
| 207 | \$30,600 | \$7,800 |
| 208 | \$24,900 | \$8,500 |
| 209 | \$24,000 | \$8,200 |
| 210 | \$24,000 | \$8,200 |
| 211 | \$18,750 | \$6,400 |
| 212 | \$20,200 | \$6,900 |
| 301 | \$26,600 | \$6,800 |
| 302 | \$28,700 | \$7,300 |
| 303 | \$11,450 | n/a |
| 304 | \$11,450 | n/a |
| 305 | \$14,550 | n/a |
| 306 | \$14,800 | n/a |

Contact

Andrew Clark

aclark@expoships.com • +44 1517228600

Ginger Hornaday

ghornaday@expoships.com • +1 954 682 2196

David Lester

dlester@expoships.com • +1 239 272 5851

www.ifaef.com

www.expoships.com

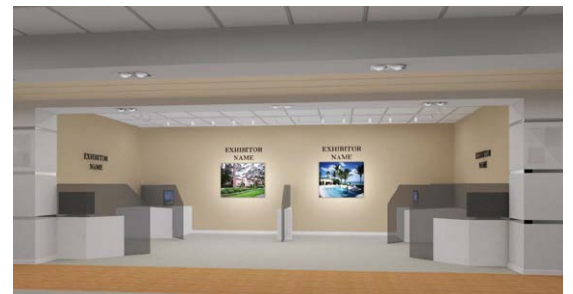

Shared by Four Exhibitors



Shared by Three Exhibitors



Single Exhibitor



GRAND LUXE

SEAFAR



The Venue

The \$40 million, 3,200 ton yacht features 4 decks, 28 custom designed exhibition/meeting spaces (12,000 sf), glass-walled club lounge/dining room, open-air lounge, international coffee bar, and open-air sky deck bar & bistro.

EXHIBITION SPACES

Locations: Decks 1, 2 & 3 Square Footage: 12,000

CLUB LOUNGE / DINING ROOM

Location: Deck 3

Seated Capacity: 120 Reception Capacity: 250

SKY DECK

Location: Deck 4

Seated Capacity: 150 Reception Capacity: 350

LUXE LOUNGE

Location: Deck 2 Aft Reception Capacity: 30

INTERNATIONAL COFFEE BAR

Location: Deck 1 Aft Reception Capacity: 30





199 E. Flagler St, #1760, Miami, FL 33131 • www.expoships.com